

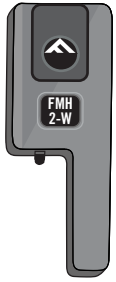

INSTALLATION & PROGRAMMING GUIDE FOR

FORTIN® **RFK-442 REMOTE TRANSMITTER KIT**

PARTS INCLUDED



ANT-FMH-2W
ANTENNA

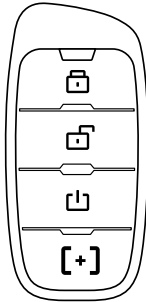

2x RM442
REMOTES

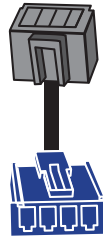

ANTENNA
CABLE

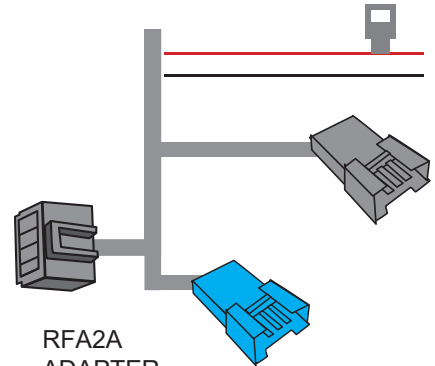

RFA2A
ADAPTER

This guide will show you how to connect the RFK-442 add-on RF remote transmitter kit to an EVO-ALL that is installed in a vehicle using only WIRE-TO-WIRE connections WITHOUT using a T-Harness or separate remote start controller.

STEP 1. VERIFY BASIC EVO-ALL OPERATION

Before beginning the RF remote kit installation, it is best to verify basic operation of your EVO-ALL. Your installation tip sheet will show you the vehicle wiring & programming procedure for your EVO-ALL. This must be completed before adding the RF remote kit. After completing the vehicle programming procedure your OEM remotes should be able to remote start the vehicle.

IF OPTION AVAILABLE. To remote start the vehicle with the factory key fob :



PRESS LOCK 3 TIMES (By default)
or **PRESS LOCK UNLOCK LOCK.**

Remote-start the vehicle.

*In some vehicles, the lock information is not present as a data signal. If the blue light does not flash on your EVO-ALL when you press the lock button on your OEM remote after successful vehicle programming, then the EVO-ALL does not detect the lock information from the vehicle CAN data bus. If the lock data information is not present in your vehicle, then just make sure the vehicle programming procedure gave the expected light flashes and proceed with the RF remote kit installation.

**Some vehicles do not come with OEM remotes. If your vehicle did not come with OEM remotes, then just make sure the vehicle programming procedure gave the expected light flashes and proceed with the RF remote kit installation.

STEP 2. INSTALL THE ANTENNA

The antenna mast should be mounted at the top of the interior side of windshield.

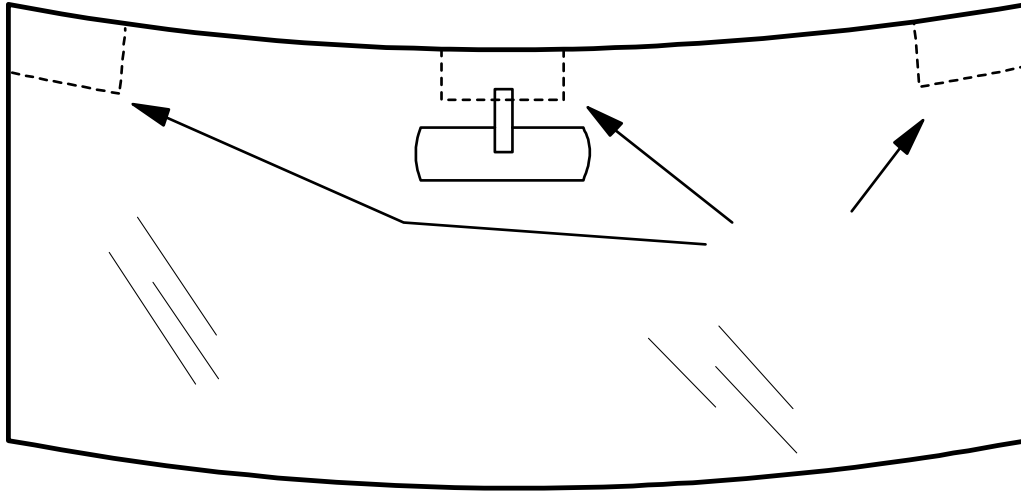

Tuck the antenna wire into the headliner, as you route it towards the driver side "A" pillar. Then tuck the wire into the "A" pillar as you route it down towards the driver side under dash area or wherever your EVO-ALL module is located.

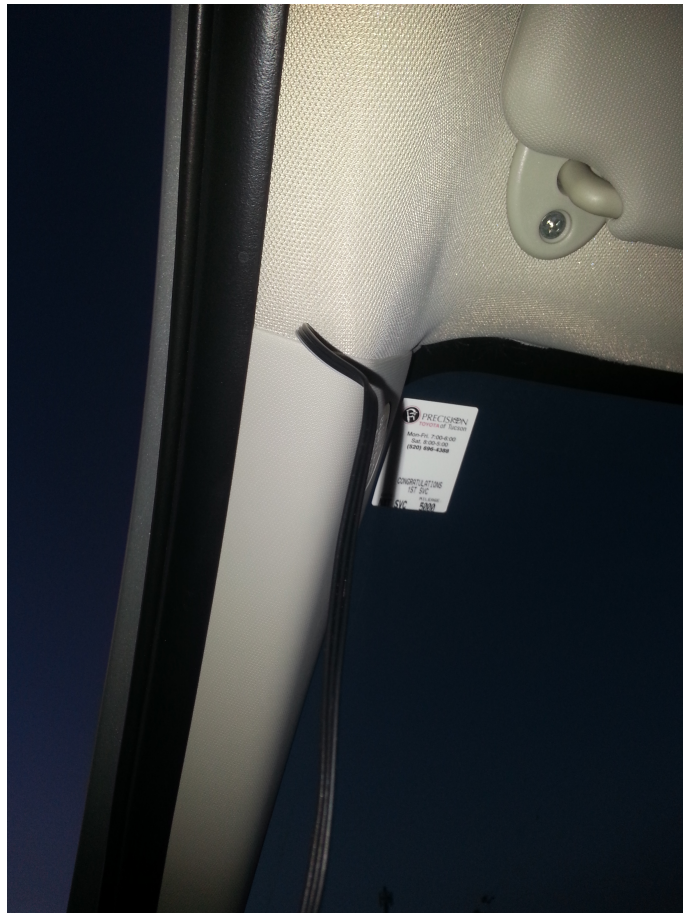

STEP 3. MAKE THE CONNECTIONS

Your EVO-ALL comes with a 4-pin "data-link" cable. This has a black male 4-pin plug (without locking tab) on one end, and a black male 4-pin plug (with locking tab) at the other end. Some data-link harnesses also have a white 4-pin plug on the end along with the black locking tab plug. This cable will NOT be used in this configuration as it will be replaced with the RFA2A adapter.

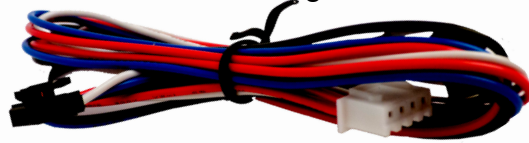

4-Pin data link Connector
(Not Used)

- 1) First, connect the RED wire from the RFA2A adapter to a constant power source in your vehicle. Refer to your installation Tip Sheet for where to connect constant (+) 12 Volts.
- 2) Next, connect the BLACK wire from the RFA2A adapter to vehicle Ground. Refer to your installation Tip Sheet for where to connect (-) Ground. This will typically connect to a bolt mounted to a solid metal surface in the under dash area of the vehicle.
- 3) Next, plug the blue male 4-pin antenna plug into the blue female plug of the RFA2A adapter.

*The black female plug of the RFA2A adapter is not used in this configuration.

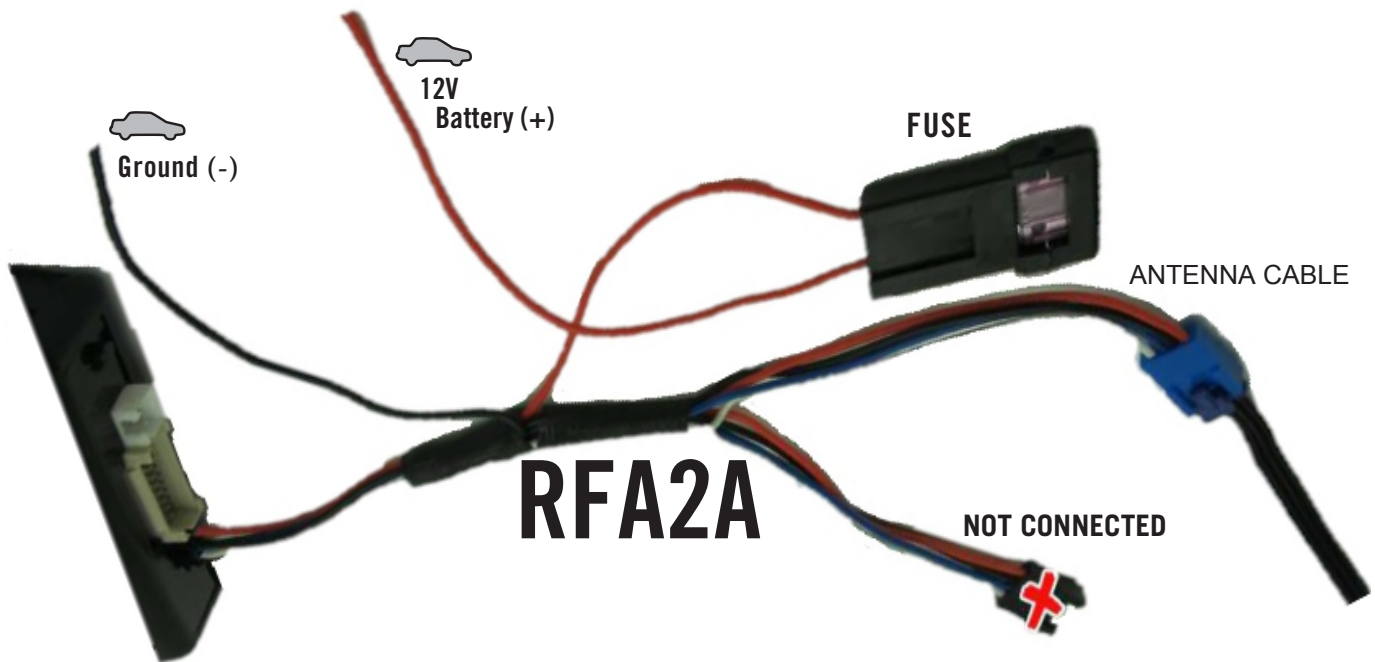

RFA2A Hardwire Diagram:

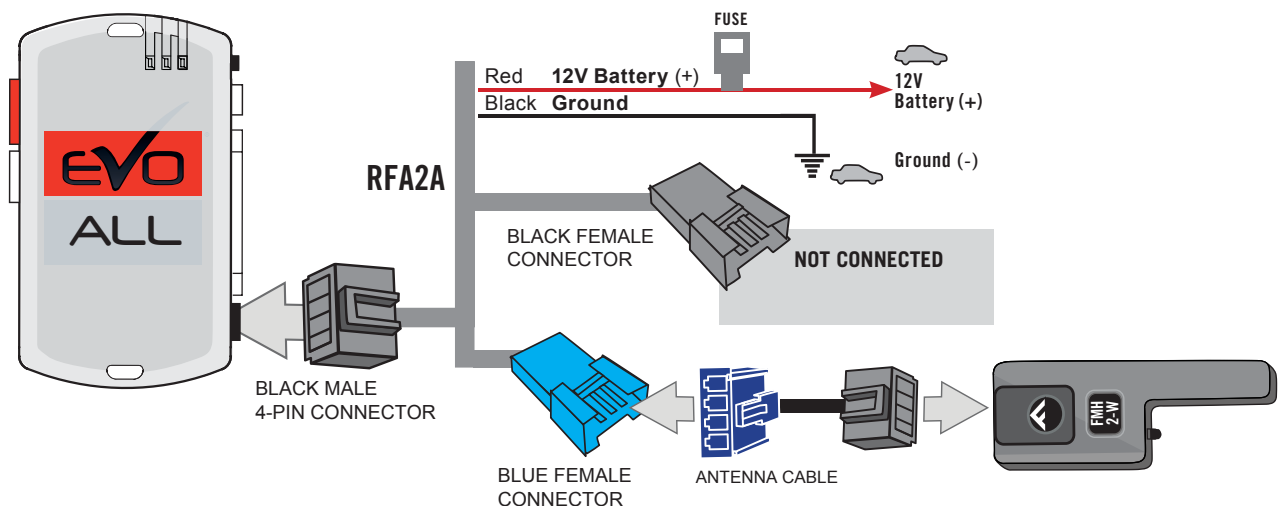

STEP 4. REMOTE PROGRAMMING

Once your connections are made, you will need to program your remote transmitters to sync with your EVO-ALL. Perform the following steps:

1

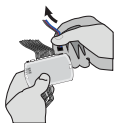

Begin with the 4 Pin (Data-Link) connector unplugged from the EVO-ALL module.

2

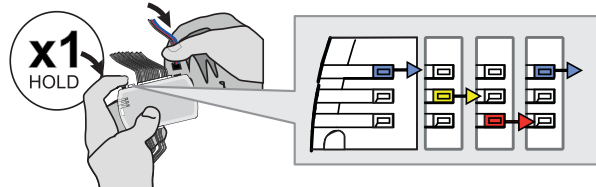

Press and hold the programming button as you insert the black male 4-Pin plug (without locking tab) from the RFA2A adapter.

The LEDs will begin to cycle between the colors

3

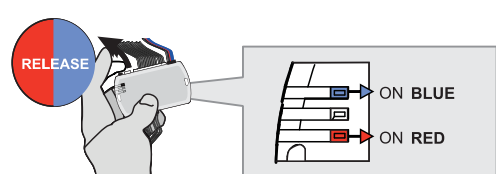

Release the programming button at the moment when the LEDs are BLUE & RED.

If the LED are not solid BLUE and RED disconnect the 4-Pin connector (Data-Link) and go back to step 1.

4

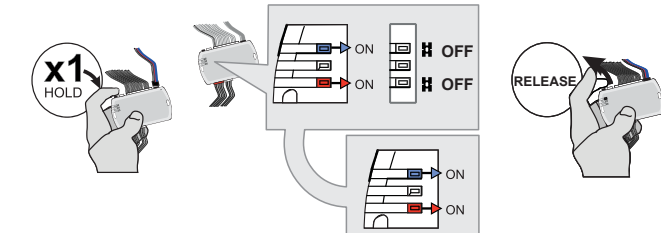

Press and hold the programming button. The BLUE and RED LEDs will turn Off. **Wait** until the BLUE and RED LEDs turn back ON, **then release the button**

5

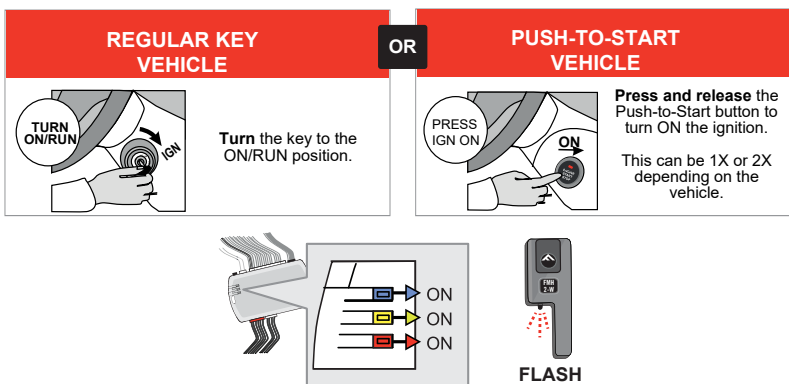

Turn ignition on.



The YELLOW LED will turn on along with the BLUE and RED.

The antenna will flash rapidly.

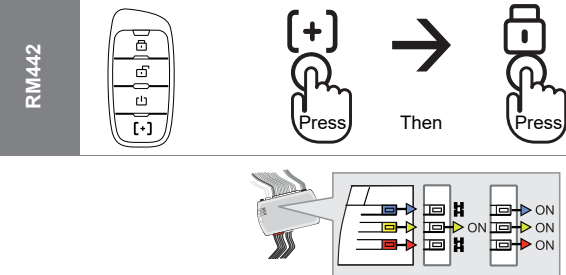
6



On each Transmitter

Press and release the **AUX** button 
THEN
Press and release the **LOCK** button 

The BLUE and RED LEDs will flash once each time to confirm.

7

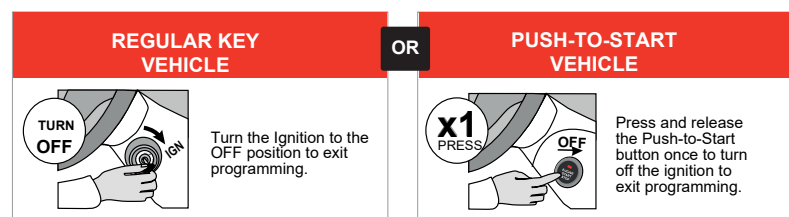

Turn Ignition OFF.







The EVO-ALL LEDs will turn Off.

The remotes are now programmed.

STEP 5. TEST THE SYSTEM

Once programming is complete, test the remotes for operation.

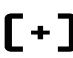
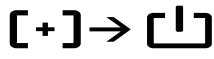
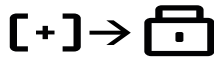
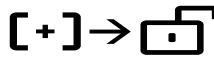
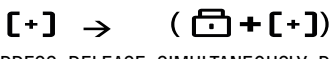
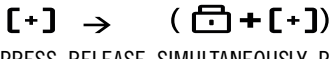
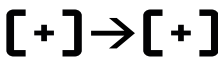
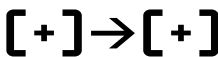
USING THE REMOTE CONTROL

BUTTON	COMMAND	TIME PRESSED SECOND	CONFIRMATION	DESCRIPTION	
 PRESS	LOCK	1 SEC.	1 beep 1 Green flash	Locks all doors, arms the anti-theft system and activates the Alarm (if available).	
 PRESS	PANIC	3 SEC.	1 beep 1 Green flash	Press LOCK for 3 seconds to activate the Panic.	
 PRESS	UNLOCK	1 SEC.	2 beep 2 Green flash	Unlocks all doors, disarms the anti-theft system and deactivates the Alarm (if available).	
 PRESS	START	3 SEC.	ASCENDING SOUND 2 Green flash	Remote start the vehicle. Press START again to reset the runtime.	
 PRESS	TRUNK	3 SEC.	1 beep 1 Green flash	Opens the trunk, and deactivates the Alarm (if available). The Alarm ignores the trunk zone until it is closed.	
 PRESS RELEASE PRESS	STOP	1 SEC.	DESCENDING SOUND 2 Red flash	Cancel the remote start sequence.	
 PRESS RELEASE PRESS	AUXILIARY1	1 SEC.	1 beep 1 Green flash	Activates the auxiliary1 (if available).	
 PRESS RELEASE PRESS	AUXILIARY2	1 SEC.	1 beep 1 Green flash	Activates the auxiliary2 (if available).	
 PRESS RELEASE SIMULTANEOUSLY PRESS	DISABLE THE REMOTE BUTTONS	3 SEC.	UNTIL THE RED LED TURN ON	Disable all the remote's buttons for safety. (Optional, disable by default)	
 PRESS RELEASE SIMULTANEOUSLY PRESS	ENABLE THE REMOTE BUTTONS	3 SEC.	UNTIL THE GREEN LED TURN ON	Enables the buttons on the remote. (Optional, disable by default)	
 PRESS RELEASE PRESS				THE STATUS OF THE REMOTE-STARTERS OR ALARM SYSTEM CAN BE QUERIED VIA REMOTE CONTROL	
 PRESS RELEASE PRESS		STATUS REQUEST	1 SEC.	1 beep 1 Green Flash	The vehicle is LOCKed (and ARMED, if available).
			2 beep 2 Green Flash	The vehicle is UNLOCKed (and DISARMED, if available).	
			ASCENDING SOUND 2 Green Flash	The vehicle is running by remote-start.	
LED DIAGNOSTIC	WHEN THE REMOTE'S BLUE LED FLASHES 6 TIMES AND THE RED LED IS ON FOR ONE SECOND:			The vehicle is out of range.	
	WHEN THE REMOTE EMITS A LONG BEEP AND THE RED LED IS ON FOR ONE SECOND:			The remote's buttons are DISABLED.	
	WHEN THE REMOTE EMITS A BEEP AND THE GREEN LED IS ON ONE SECOND:		The command has been sent successfully.		

REMOTE-STARTING THE VEHICLE

STEP 1



To remote-start the vehicle press the START button for approximately 3 second.

STEP 2



The vehicle ignition will turn on to indicate a response to the Remote-Start signal.

STEP 3



Approximately 5 seconds later the engine will crank and remain on for the entire duration of the Remote-Starter runtime, or until the Remote-Starter is shut down.

If the EVO-ALL fails to start the vehicle on the first attempt, it will wait 3 seconds before it will attempt to start the vehicle again. The Remote-Starter will attempt to start the vehicle 2 times (default) before giving up. When a EVO-ALL fails to remote start, it will flash its red light a number of times as a diagnostic to tell you why it failed.

EVO-ALL REMOTE START DIAGNOSTICS

RED Light flashes :

2x	Normal stop (Brake, Park Brake)
3x	No tachometer signal detected
4x	Ignition On
5x	Hood open

KEY TAKEOVER FOR STANDARD KEY VEHICLE	KEY TAKEOVER FOR PUSH-TO-START FORD / HYUNDAI / INFINITI / KIA / MAZDA / NISSAN / SUBARU*	KEY TAKEOVER FOR PUSH-TO-START ACURA/HONDA/LEXUS / SCION TOYOTA *	KEY TAKEOVER FOR PUSH-TO-START AUDI / BMW / CHRYSLER / GMC*
STEP 1 Do not press the foot brake (the engine will shut down).	STEP 1 Enter the vehicle with the SMART-KEY.	STEP 1 The module will shut down the vehicle as soon as the drivers door is opened. OFF	STEP 2 Press the foot brake.
STEP 2 Insert the key into the ignition and turn to ON position.	STEP 2 Do not press the foot brake.		STEP 3 The vehicle can now be now be put in to gear and driven.
STEP 3 Press the foot brake.	STEP 3 Press the Push-to-Start button 1x or 2x to turn ignition on.		
	STEP 4 Press the foot brake.		
	STEP 5 The vehicle can now be put in to gear and driven. If the Smart-Key is not detected the vehicle will shut down.		